

NOTES:

- 1) SAWCUT THROUGH GUTTER PLATE SHALL BE MADE AS CLOSE TO CURB FACE AS POSSIBLE.
- 2) COMPLETE CURB AND GUTTER SHALL NOT BE REMOVED UNLESS DIRECTED BY THE CITY ENGINEER.
- 3) WHEN STRAIGHT CURBS ARE REMOVED, AC PAVEMENT SHALL BE REPLACED AS NEEDED OR DIRECTED BY CITY ENGINEER.
- 4) WHEN ENTIRE GUTTER PLATE IS REMOVED THE EXISTING PAVEMENT WILL BE UNDERCUT TO PROVIDE CONCRETE SUPPORT UNDER PAVEMENT. (SEE VALLEY GUTTER DETAILS DWG. NO. 20).

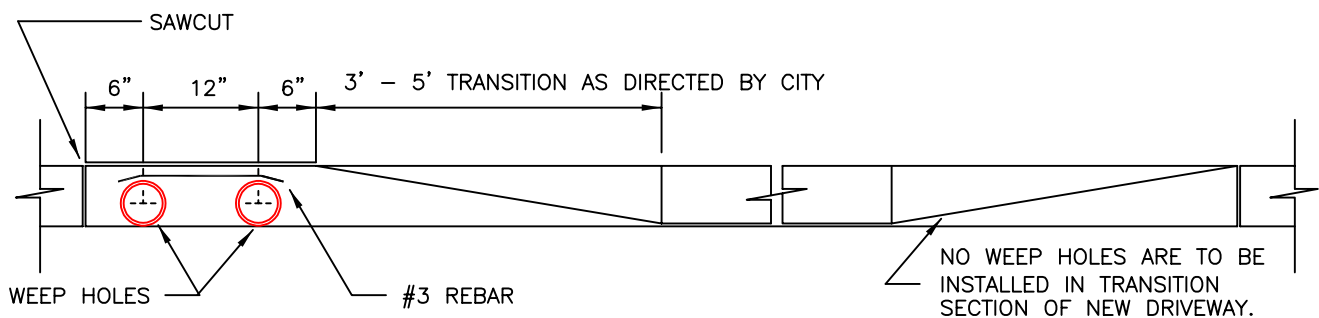
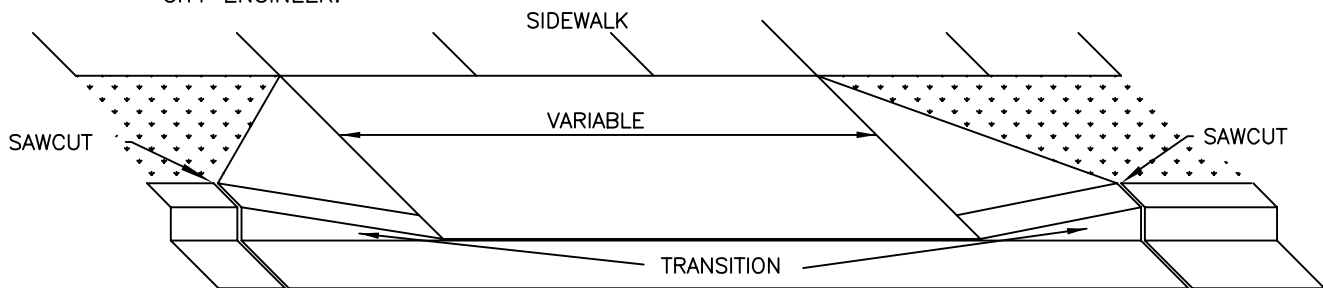

OPTIONAL DRIVEWAY CUT WITH WEEPHOLES

**City of
McMinnville**

**DETAIL FOR
CURB KNOCKOUT FOR
DRIVEWAYS**

DRAWN BY:
JG

DATE:
FEB 2025

DRAWING NO.
5